



CE  II 2G c T6

## Low pressure paint spray gun with atomizing air Mod 90

Paint circuit totally in stainless steel compatible with all traffic paint.

### Connections:

- drive air inlet 1/4"
- atomizing air inlet 3/8"
- material inlet 3/4"
- Ø passage of paint 14,5 mm

**Material nozzle in stainless steel:** Ø 6 to 10 mm / Single needle Ø 11 mm

**Special air nozzle in stainless steel:** Ø 10 to 13,8 mm

**External nozzles:** a wide choice available in stainless steel, or in tungsten carbide to meet all your needs in performance and width of lines. The tungsten carbide nozzles have a lifetime much bigger than those in steel (approximately 3 times). The choice of external nozzle will depend on the material nozzle diameter (see the list of nozzles on our website).

One inlet is provided for flushing the head, especially for waterborne traffic paint. The inlet's plug will be replaced by a connection (on request).

It is possible to mount a system with tungsten carbide to limit the width of the line. (Option)

Dimension: 220 x 70 mm

Weight: 3,1 kg

### Advice:

- for the paint using preferably a pipe with a minimum internal diameter of 19 mm
- for air using preferably a pipe with an internal diameter of 10 mm
- for a good performance use an atomizing air pressure below the pressure in the paint tank
- using a drive air pressure of 6 bars (87 psi)

**Kamber SA**  
**Chemin des Champs Courbes 19**  
**CH - 1024 Ecublens**

**Tél. +41 (0)21 691 69 51**  
**Fax +41 (0)21 691 69 54**

**e-mail: info@kambersa.ch**

# 90

PISTOLET PNEUMATIQUE PEINTURE POUR LA SIGNALISATION ROUTIERE  
 FARBSPRITZPISTOLE FÜR DIE STRASSENMARKIERUNG  
 PNEUMATIC PAINT SPRAY GUN FOR ROAD MARKING  
 PISTOLA PNEUMATICA PER VERNICI PER LA SEGNALETICA STRADALE  
 PISTOLA NEUMATICA PARA PINTURA PARA LA SENALIZACION VIAL

*Kamber S.A.*

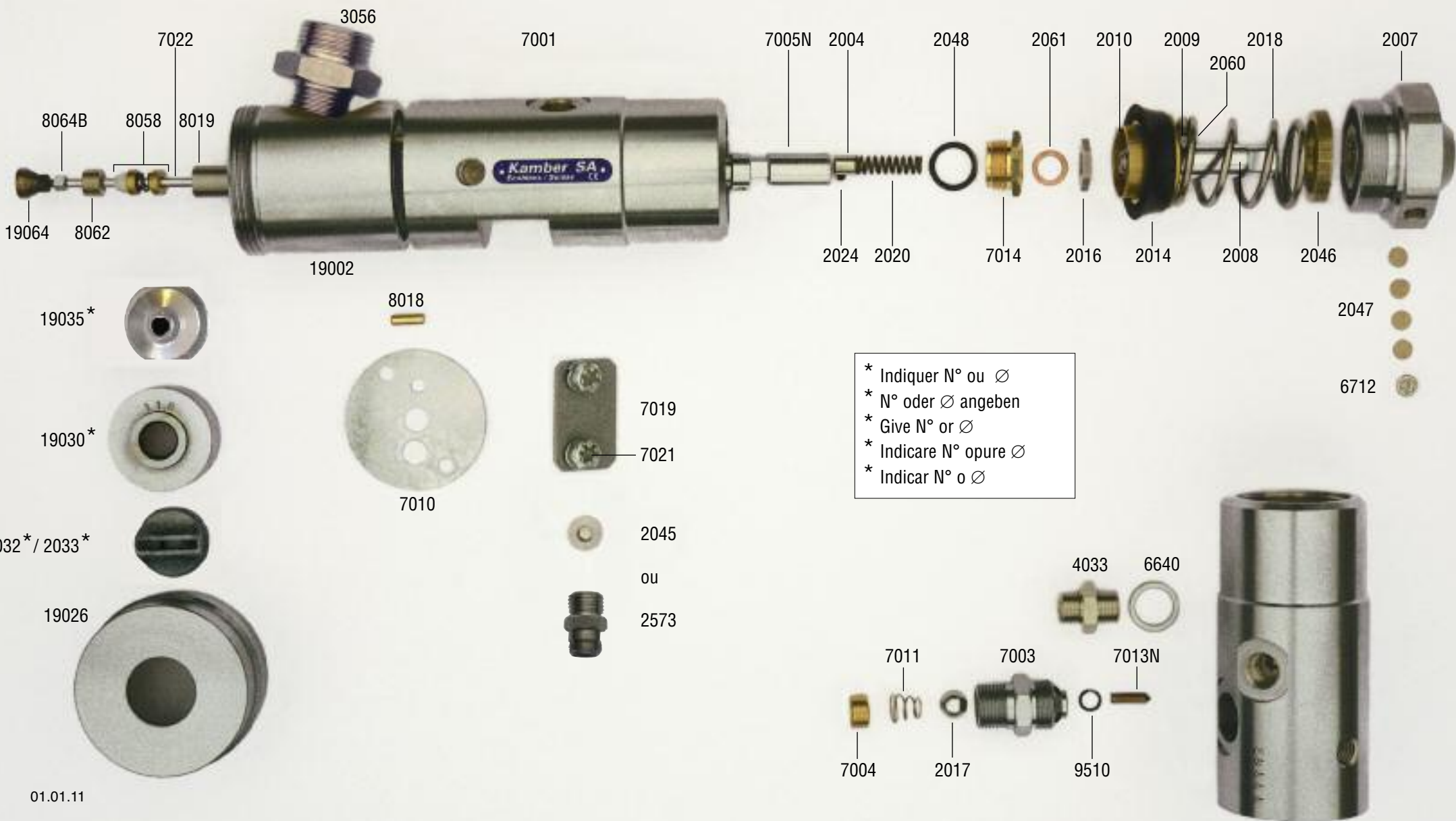

\* Indiquer N° ou Ø  
 \* N° oder Ø angeben  
 \* Give N° or Ø  
 \* Indicare N° oppure Ø  
 \* Indicar N° o Ø

**84** | **38**  
**80** | **90**

ACCESSOIRES POUR PISTOLETS PNEUMATIQUES PEINTURE  
 ZUBEHÖR FÜR PNEUMATISCHE FARBSPRITZPISTOLEN  
 ACCESSORIES FOR PNEUMATIC PAINT SPRAY GUNS  
 ACCESSORI PER PISTOLE PNEUMATICE DA VERNICI  
 ACCESORIOS PARA PISTOLAS NEUMATICAS PINTURA

*Kamber S.A.*

2034

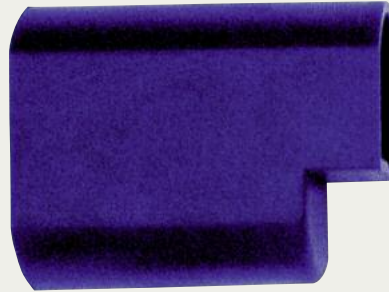

2058 - MD



19058-MD



2037

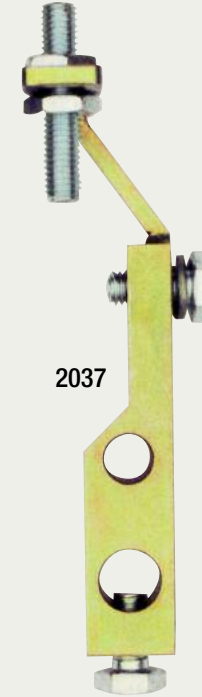

2028



2057



2023



	MOD 84	MOD 38	MOD 80	MOD 90
2028	●	●	●	●
2057	●	●	●	●
2023	●	●	●	
2034		●		
OPTIONS				
2037		●		
7020			●	●
2058-MD	●	●	●	
19058-MD				●

7020





*Kamber S.A.*

**List of nozzles Mod 90**

Nozzles set		A	B	C	D	E	F			
Needle	∅	11.0	<b>11.0</b>	<b>11.0</b>	<b>11.0</b>	<b>11.0</b>	<b>11.0</b>			
				7022 + 19064						
Material nozzle	∅	5.0	<b>6.0</b>	<b>7.0</b>	<b>8.0</b>	<b>9.0</b>	<b>10.0</b>			
		19035A	19035B	19035C	19035D	19035E	19035F			
Basic air nozzle	∅	10	<b>10</b>	<b>11.8</b>	<b>11.8</b>	<b>13.8</b>	<b>13.8</b>			
		19030AB		19030CD		19030EF		slot width (mm)	spraying width (mm)	application
External nozzle	N°	20 – <b>20</b>	20 – <b>20</b>					2.5	10 – 15	large output
Stainless steel=2032-		21	21					2.5	15 – 23	large output
<b>Carbide=2033-</b>		22	22	22				3.0	15 – 23	very large output
				<b>23</b>				2.5	20 – 40	large output
				<b>24</b>				2.5	50	standard
				25 – <b>25</b>				3.0	10 – 18	very large output
				<b>28</b>				3.0	20 – 40	very large output
					<b>40</b>	<b>40</b>	<b>40</b>	3.0	10 – 16	large output
					<b>41</b>	<b>41</b>	<b>41</b>	3.5	10 – 25	very large output
					<b>42</b>	<b>42</b>	<b>42</b>	3.8	10 – 25	very large output
					<b>44</b>	<b>44</b>	<b>44</b>	3.5	25 – 35	very large output

Example : Gun Mod 90 with set of nozzles B (needle 19064 ∅11.0 - material nozzle 19035B ∅6.0 - basic air nozzle 19030AB ∅10.0) and external nozzle **2033-20** or 2032-20